

## Product Group 6

**Fittings for Cargo Restraint Systems, vital if cargo is to be transported safety.**



18mm + 25 mm

Fitting for cargo restraint system

5703-18



5700-25



5701-25



Gurt 1,5 - 2,2 mm

5702-25



Gurt 1,2 - 1,7 mm

5704-25



Gurt 1,8 - 2,2 mm

5706-25



Die angegebenen Bruchlastwerte beziehen sich auf den Klemmschloßrahmen. Die Bruch-lastermittlung des kompletten Systems obliegt dem Systemhersteller.

The breaking strenght indicated refers to the frame of the cam buckle. To determine the breaking strenght of the complete system, this must be performed after final assembly. Les charges de rupture indiquees concernent les cadres de boucles a came. La determination des charges de rupture du systeme d'arrimage complet incombe a son fabricant.

Las cargas de rotura indicadas de refieren al marco del cierre de apriete. La determinación de la carga de rotura del sistema completo corresponde al fabricante del sistema.

5710-25

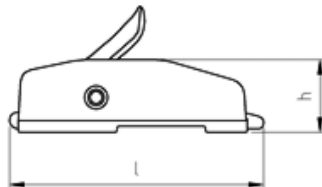

Article No.	Ident No.	Surface	Material	webbing mm	h mm	l mm	BS daN	SWL daN		100 pcs. kg	EAN-No. 4012053
5703-18	932758	vz	ZD	18	10,0	34,5	250	125	800	2,1	12671 8
5700-25	929946	ge	NO	25	22,0	65,0	750	375	250	11,4	12670 1
5701-25	931933	bl	ZD	25	15,0	52,0	450	225	500	4,8	12680 0
5702-25	930383	bl	ZD	25	12,0	44,0	250	125	500	3,6	12690 9
5704-25	929949	bl	ZD	25	17,0	54,0	500	250	300	7,0	12930 6
5706-25	950024	bl	ZD	25	13,0	67,0	500	250	200	6,5	12672 5
5710-25	930390	bl	A4	25	20,0	66,0			250	3,8	12660 2

234-B-25



234-25



234-V2-25



234-IB-25



234-IV2-25



Article No.	Ident No.	Surface	Material	webbing mm	h mm	l mm	BS daN	SWL daN		100 pcs. kg	EAN-No. 4012053
234-B-25	929935	sc	NO	25	35,0	115,0	800	400	100	20,7	12700 5
234-25	931619	ge	NO	25	42,0	133,0	1000	500	50	35,0	12710 4
234-V2-25	929934	ge	HS	25	43,0	132,0	1500	750	60	39,7	12720 3
234-IB-25	932757	bl	NS	25	40,0	109,0	500	250	100	21,7	12702 9
234-IV2-25	932756	bl	NS	25	40,0	133,0	1500	750	60	34,1	12721 0

5745-VC-25



5720-R-25



5726-25



5726-S-25



2311-TR-30



5723-25



5725-25



Article No.	Ident No.	Surface	Material	webbing mm	h Ø mm	l mm	BS daN	SWL daN		100 pcs. kg	EAN-No. 4012053
5745-VC-25	929950	pv	NO	25	7,0	105,0	500	250	200		12730 2
5720-R-25	930077	ge	HS	25	8,0	79,0	1500	750	250	10,5	12740 1
5726-25	930061	ge	HS	25	6,0	34,0	1000	500	200	3,3	12750 0
5726-S-25	930055	ge	HS	25	7,0	54,0	1000	500	200	6,4	12751 7
2311-TR-30	931019	vz	NO	30	-	120,0	1800	900	20	20,9	12760 9
5723-25	933796	ge	HS	25	4,0	83,0	1000	500	100	8,4	12741 8
5725-25	930060	vz	HS	25	3,0	53,0	1500	750	250	4,2	12961 0

36 mm

5705-36



5712-WH-36



5712-36



5734-36



5736-36



5736-1-36



5783-36



Article No.	Ident No.	Surface	Material	webbing mm	h Ø mm	l mm	BS daN	SWL daN		100 pcs. kg	EAN-No. 4012053
5705-36	931364	bl	ZD	36	22,0	60,0	600	300	200	12,3	12780 7
5712-WH-36	930047	ge	HS	36	42,0	155,0	3000	1500	40	41,2	12770 8
5712-36	931618	ge	HS	36	49,0	160,0	3000	1500	40	55,9	12780 7
5734-36	950023	ge	HS	36	9,0	52,0	2200	1100	1	10,6	12891 0
5736-36	933022	ge	HS	36	11,0	90,0	2200	1100	1	17,2	12790 6
5736-1-36	933020	ge	HS	36	9,0	73,0	3000	1500	200	13,2	12791 3
5783-36	905963	vz	NO	36	18,0	144,5	2200	1100	10	40,6	12800 2

50mm

5711-50



235-3-50



235-1-50



235-LP-50



Article No.	Ident No.	Surface	Material	webbing mm	h mm	l mm	BS daN	SWL daN		100 pcs. kg	EAN-No. 4012053
5711-50	919840	po	HS	50	23,0	137,0	2000	1000	50	30,4	12950 4
235-3-50	931617	ge	HS	50	55,0	170,0	3000	1500	20	96,5	12810 1
235-1-50	932251	ge	HS	50	61,0	230,0	5000	2500	20	114,5	12821 7
235-LP-50	931787	ge	HS	50	68,0	335,0	5000	2500	12	156,1	09404 8

232-50



233-50



5730-50



5751-50



Article No.	Ident No.	Surface	Material	webbing mm	h Ø mm	l mm	BS daN	SWL daN		100 pcs. kg	EAN-No. 4012053
232-50	929932	ge	HS	50	5,0	150,0	5000	2500	25	25,7	12840 0
233-50	929933	ge	HS	50	6,0	155,0	5000	2500	25	31,4	12850 7
5730-50	925864	ge	HS	50	15,0	107,0	5000	2500	10	63,9	12880 4
5751-50	932657	ge	HS	50	30,0	72,0	1000	500	200	9,1	12940 5

5729-50



5731-M-50



5731-K-50



5743-50



5744-50



Article No.	Ident No.	Surface	Material	webbing mm	Ø mm	l mm	BS daN	SWL daN		100 pcs. kg	EAN-No. 4012053
5729-50	930056	ge	HS	50	12,0	75,0	5000	2500	50	16,5	12860 6
5731-M-50	934985	ge	HS	50	11,0	90,0	5000	2500	1	23,7	12870 5
5731-K-50	930049	ge	HS	50	11,0	74,0	5000	2500	1	21,3	12871 2
5743-50	933672	ge	HS	50	11,5	140,0	2000	1000	1	27,4	12971 9
5744-50	933817	ge	HS	50	14,5	130	5000	2500	25	39,9	12972 6

5733-50



5733-R-50



5746-50



5746-S-50



5732-50



5731-50-NS



Article No.	Ident No.	Surface	Material	webbing mm	Ø mm	l mm	BS daN	SWL daN		100 pcs. kg	EAN-No. 4012053
5733-50	933818	ge	HS	50	6,0	66,0	5000	2500	25	13,5	12902 3
5733-R-50	930046	ge	HS	50	12,0	90,0	5000	2500	50	17,8	12900 9
5746-50	929951	ge	HS	50	12,5	160,0	5000	2500	50	47,3	12910 8
5746-S-50	929952	ge	HS	50	12,5	160,0	5000	2500	50	49,1	12920 7
5732-50	918319	ge	HS	50	4,2	110,0	2700	1350	100	15,2	12890 3
5731-50-NS	934987	ge	HS	50	12,0	138,0	5000	2500	1	46,2	12872 9

45 mm

5784-45



Article No.	Ident No.	Surface	Material	webbing mm	Ø mm	l mm	BS daN	SWL daN		100 pcs. kg	EAN-No. 4012053
5784-45	905088	ge	NO	45	5,0	63,0	1600	800	1	4,5	12801 9



5t belt systems



Article No.	System No.	webbing mm	webbing thickness mm	system length m	colour	LC 12195-2 daN	safe pulling force daN	weight kg
5t 8m	<b>959993</b>	50	3,3	8	orange	2500	5000	2,8
5t 9m	<b>959992</b>	50	3,3	9	orange	2500	5000	3,0

All systems are equipped with 2 hooks and 1 ratschet.

Sling EN 1492-1



Article No.	Ident No.	SWL daN	EWL* m	bandwidth mm	colour	EAN-No. 40 12053
HB - 1000 - 1,00	<b>959200</b>	1000	1,00	30,00	violet	13580 2
HB - 1000 - 2,00	<b>959201</b>	1000	2,00	30,00	violet	13581 9
HB - 1000 - 3,00	<b>959202</b>	1000	3,00	30,00	violet	13582 6
HB - 1000 - 4,00	<b>959203</b>	1000	4,00	30,00	violet	13583 5
HB - 1000 - 5,00	<b>959204</b>	1000	5,00	30,00	violet	13584 0
HB - 1000 - 6,00	<b>959205</b>	1000	6,00	30,00	violet	13585 7
HB - 2000 - 2,00	<b>959206</b>	2000	2,00	60,00	green	13586 4
HB - 2000 - 3,00	<b>959207</b>	2000	3,00	60,00	green	13587 1
HB - 2000 - 4,00	<b>959208</b>	2000	4,00	60,00	green	13588 8
HB - 2000 - 5,00	<b>959209</b>	2000	5,00	60,00	green	13589 5
HB - 2000 - 6,00	<b>959210</b>	2000	6,00	60,00	green	13590 1
HB - 2000 - 8,00	<b>959211</b>	2000	8,00	60,00	green	13591 8
HB - 3000 - 2,00	<b>959212</b>	3000	2,00	90,00	yellow	13582 5
HB - 3000 - 3,00	<b>959213</b>	3000	3,00	90,00	yellow	13593 2
HB - 3000 - 4,00	<b>959214</b>	3000	4,00	90,00	yellow	13594 9
HB - 3000 - 5,00	<b>959215</b>	3000	5,00	90,00	yellow	13595 6
HB - 3000 - 6,00	<b>959216</b>	3000	6,00	90,00	yellow	13596 3
HB - 3000 - 8,00	<b>959217</b>	3000	8,00	90,00	yellow	13597 0
HB - 4000 - 2,00	<b>959218</b>	4000	2,00	120,00	grey	13598 7
HB - 4000 - 3,00	<b>959219</b>	4000	3,00	120,00	grey	13599 4
HB - 4000 - 4,00	<b>959220</b>	4000	4,00	120,00	grey	13600 7
HB - 4000 - 5,00	<b>959221</b>	4000	5,00	120,00	grey	13601 4
HB - 5000 - 4,00	<b>959222</b>	5000	4,00	150,00	red	13602 1
HB - 5000 - 5,00	<b>959223</b>	5000	5,00	150,00	red	13603 8
HB - 5000 - 6,00	<b>959224</b>	5000	6,00	150,00	red	13604 5
HB - 5000 - 8,00	<b>959225</b>	5000	8,00	150,00	red	13605 2
HB - 6000 - 4,00	<b>959226</b>	6000	4,00	180,00	brown	13606 9
HB - 6000 - 5,00	<b>959227</b>	6000	5,00	180,00	brown	13607 6
HB - 6000 - 6,00	<b>959228</b>	6000	6,00	180,00	brown	13608 3
HB - 6000 - 8,00	<b>959229</b>	6000	8,00	180,00	brown	13609 0

\* = effectiv working lenght

Veiligheids faktor / Sicherheitsfaktor / Safety Factor 7:

Round sling EN 1492-2

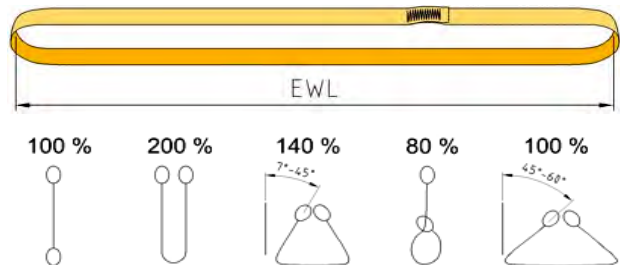

Article No.	Ident No.	SWL daN	EWL* m	bandwidth mm	colour	EAN-No. 40 12053
RS - 1000 - 0,50	<b>959100</b>	1000	0,50	50	violet	13510 9
RS - 1000 - 1,00	<b>959101</b>	1000	1,00	50	violet	13511 6
RS - 1000 - 1,50	<b>959102</b>	1000	1,50	50	violet	13512 3
RS - 1000 - 2,00	<b>959103</b>	1000	2,00	50	violet	13513 0
RS - 1000 - 3,00	<b>959104</b>	1000	3,00	50	violet	13514 7
RS - 1000 - 4,00	<b>959105</b>	1000	4,00	50	violet	13515 4
RS - 2000 - 0,50	<b>959106</b>	2000	0,50	50	green	13516 1
RS - 2000 - 1,00	<b>959107</b>	2000	1,00	50	green	13517 8
RS - 2000 - 1,50	<b>959108</b>	2000	1,50	50	green	13518 5
RS - 2000 - 2,00	<b>959109</b>	2000	2,00	50	green	13519 2
RS - 2000 - 2,50	<b>959110</b>	2000	2,50	50	green	13520 8
RS - 2000 - 3,00	<b>959111</b>	2000	3,00	50	green	13521 5
RS - 2000 - 4,00	<b>959112</b>	2000	4,00	50	green	13522 2
RS - 3000 - 1,00	<b>959113</b>	3000	1,00	55	yellow	13523 9
RS - 3000 - 1,50	<b>959114</b>	3000	1,50	55	yellow	13524 6
RS - 3000 - 2,00	<b>959115</b>	3000	2,00	55	yellow	13525 3
RS - 3000 - 3,00	<b>959116</b>	3000	3,00	55	yellow	13526 0
RS - 3000 - 4,00	<b>959117</b>	3000	4,00	55	yellow	13527 7
RS - 4000 - 2,00	<b>959118</b>	4000	2,00	60	grey	13528 4
RS - 4000 - 3,00	<b>959119</b>	4000	3,00	60	grey	13529 1
RS - 4000 - 4,00	<b>959120</b>	4000	4,00	60	grey	13530 7
RS - 5000 - 2,00	<b>959121</b>	5000	2,00	70	red	13531 4
RS - 5000 - 3,00	<b>959122</b>	5000	3,00	70	red	13532 1
RS - 5000 - 4,00	<b>959123</b>	5000	4,00	70	red	13533 8
RS - 6000 - 2,00	<b>959124</b>	6000	2,00	83	brown	13534 5
RS - 6000 - 3,00	<b>959125</b>	6000	3,00	83	brown	13535 2
RS - 6000 - 4,00	<b>959126</b>	6000	4,00	83	brown	13536 9
RS - 8000 - 3,00	<b>959127</b>	8000	3,00	85	blue	13537 6
RS - 8000 - 4,00	<b>959128</b>	8000	4,00	85	blue	13538 3
RS - 10000 - 3,00	<b>959129</b>	10000	3,00	112	orange	13539 0
RS - 10000 - 4,00	<b>959130</b>	10000	4,00	112	orange	13540 6

\* = effectiv working lenght

Veiligheids faktor / Sicherheitsfaktor / Safety Factor 7:1



25 mm belt systems 1-part



Article No.	Ident No.	Colour	webbing mm	l m	BS daN	clamping lock		100 pcs. kg	EAN-No. 40 12053
B25/250L4,5	<b>935059</b>	black	25	4,5	250,0	5702-25	1	16,1	132702

25 mm belt systems 2-parts with loops



Article No.	Ident No.	Colour	webbing mm	l m	BS daN	clamping lock		100 pcs. kg	EAN-No. 40 12053
B25/0250L1,95	<b>129115</b>	orange	25	1,95	250,0	5702-25	1	7,8	094024

25 mm round belt with hook and clamping lock



Article No.	Ident No.	Colour	webbing mm	l m	BS daN	clamping lock	hook		100 pcs. kg	EAN-No. 40 12053
B25/0450L1,0	<b>129118</b>	red	25	1,0	450,0	5701-25	5725-25	1	11,7	094031
B25/0450L2,0	<b>129119</b>	red	25	2,0	450,0	5701-25	5725-25	1	13,9	094055